



Deck collapses are often caused by failure of the connection where the deck is attached to the main structure due to little or no lateral capacity. ADTT-TZ is an Adjustable Deck Tension Tie designed to effectively transfer the out of plane lateral loads of the deck to the house structure.

Features:

- Adjustable design. USP WS8-EXT or 3/8-in HDG lag screws may be installed adjacent or up to 4-3/8" below deck joist (see Figure A).
- 2-hole break-out washer (BO-W) will work with multiple screw sizes.
- Blocking extensions not required.

Materials: 14 gauge

Finish: G-185 galvanizing

Installation:

- Install with USP's WS8-EXT wood screw or 3/8" HDG lag screw.
 - Drive screw horizontally and aligned vertically with the deck joist into the wall top plate of the main (house) structure.
 - Install four (4) of the specified joist fasteners into vertical legs. (Two (2) on each side of deck joist).
 - Secure front brace with six (6) specified joist fasteners.
 - Re-tighten the WS8-EXT or 3/8" HDG lag screw as needed to fully engage with the ADTT-TZ. **DO NOT OVERDRIVE.**
- Note:** Minimum 3" thread penetration required for proper installation of WS8-EXT or 3/8" lag screw.
- **For detailed installation instructions refer to www.uspconnectors.com/resources/installation-instructions.**

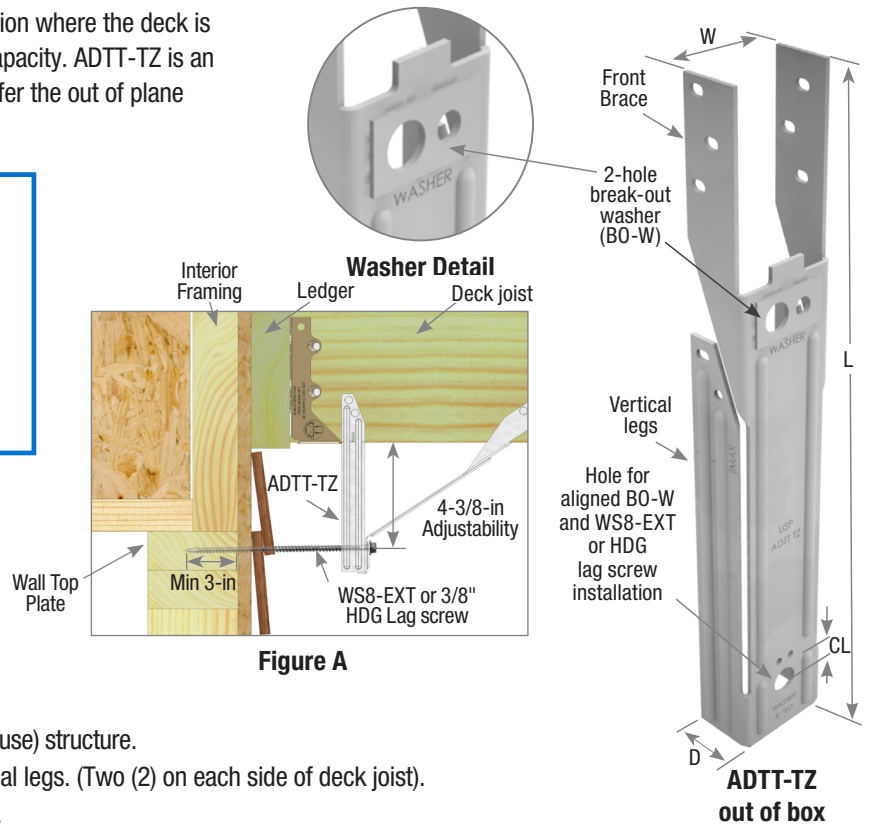
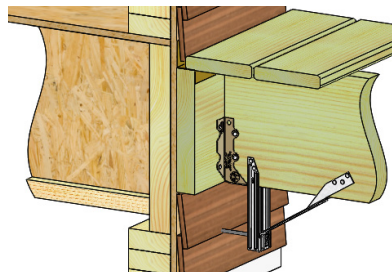
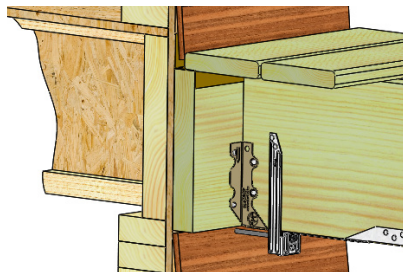

Figure A



Typical ADTT-TZ full extension installation



Typical ADTT-TZ flush installation

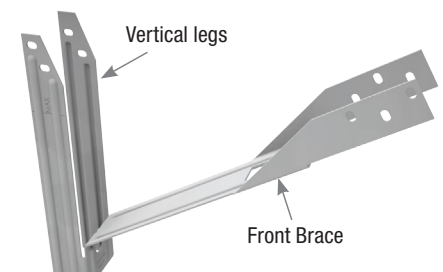

ADTT-TZ ready for installation

USP Stock No.	Ref. No.	14	Dimensions (in)				Fastener Schedule				DF Factored Resistance				S-P-F Factored Resistance				Ctn Qty
			W	L	D	CL	Wall		Joist		Lbs		kN		Lbs		kN		
							Qty	Type ^{2,3,4}	Qty	Type ^{5,7}	100%	115% ¹	100%	115% ¹	100%	115% ¹	100%	115% ¹	
ADTT-TZ	DTT1Z	14	1-9/16	10-1/2	15/16	3/8	1	3/8" HDG Lag Screw	10	10d x 1-1/2	1285	1285	5.72	5.72	1085	1090	4.83	4.85	40
							1	WS8-EXT			1305	1305	5.80	5.80	1085	1105	4.83	4.92	
							1	3/8" HDG Lag Screw	10	LL915	1285	1285	5.72	5.72	1085	1090	4.83	4.85	
							1	WS8-EXT			1305	1305	5.80	5.80	1085	1105	4.83	4.92	
ADTT-TZKT ⁶	DTT1Z-KT	14	1-9/16	10-1/2	15/16	3/8	1	WS8-EXT	10	LL915	1305	1305	5.80	5.80	1085	1105	4.83	4.92	8

1) Factored resistances have been increased 15% for short-term loads such as wind and earthquake; no further increase allowed.
 2) WS8-EXT Wood Screw is 1/4" dia. x 8" long hot-dip galvanized screw and must be ordered separately.
 3) 3/8" HDG Lag is an ASTM A307 Grade A lag screw with a thread diameter of 3/8" and is hot-dip galvanized to ASTM A153 standards. Lag screws are available at your local hardware store and must be purchased separately.
 4) Check with your siding manufacturer for recommendations for fastening through your siding material.
 5) LL915 denotes a USP LumberLok Screw, #9 x 1-3/8" long and must be ordered separately if not purchasing the kit.
 6) ADTT-TZKT is a kit with (4) ADTT-TZ packaged with USP's WS8-EXT screws and LL915 LumberLok screws.
 7) **NAILS:** 10d x 1-1/2" nails are 0.148" dia. x 1-1/2" long.

New products or updated product information are designated in blue font.